

Date: 5/12/2019

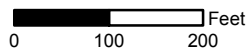

- Easement Line
- - - - Historical Lot Line
- Subdivision Line
- Tax District Line
- Page Index Boundary
- Parcel Boundary

- Special geotechnical consideration area. Steep slopes (greater than 15%) and shallow bedrock.
- Special geotechnical consideration area. Subsidence and 2,000 foot compaction or seismic fault buffer zone (includes 90% of mapped fissures).
- Special geotechnical consideration area. Potential drainage areas or recent sediment deposits. May also have solubility, clay swell, corrosion, gypsum salt, expansive or hydro-collapsible potential.
- Special geotechnical consideration area. Solubility, clay swell, corrosion, gypsum salt, expansive or hydro-collapsible potential.
- Standard geotechnical consideration area. Mixed alluvial sand and gravel.

001 Road Parcel Number
 001 Parcel Number
 1.00 Acreage
 202 Parcel Sub/Seq Number
 PB 24-45 Plat Recording Number
 5 Block Number
 5 Lot Number
 GL5 Gov. Lot Number

BOOK T23S R64E

SEC. 5

MAP N 2 NE 4

186-05-5

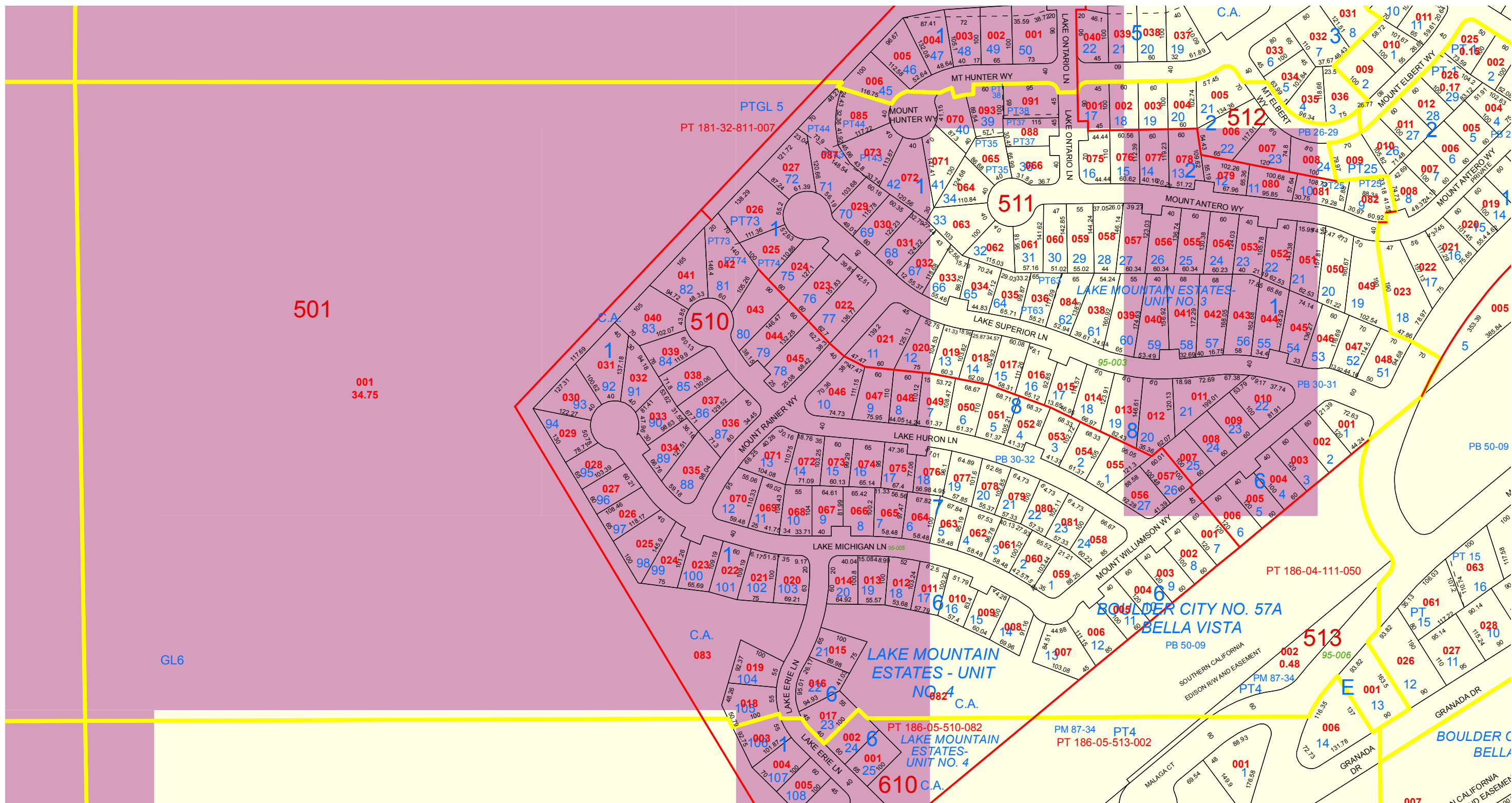
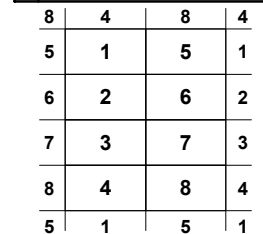
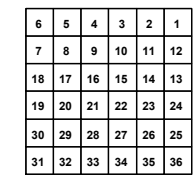
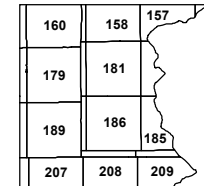

Official Soil Maps are maintained and located in the Clark County Building Department. All Conditions shown on this map are for informational purposes only.