

- Easement Line
- Historical Lot Line
- Subdivision Line
- Tax District Line
- Page Index Boundary
- Parcel Boundary

- Special geotechnical consideration area. Steep slopes (greater than 15%) and shallow bedrock.
- Special geotechnical consideration area. Subsidence and 2,000 foot compaction or seismic fault buffer zone (includes 90% of mapped fissures).
- Special geotechnical consideration area. Potential drainage areas or recent sediment deposits. May also have solubility, clay swell, corrosion, gypsum salt, expansive or hydro-collapsible potential.
- Special geotechnical consideration area. Solubility, clay swell, corrosion, gypsum salt, expansive or hydro-collapsible potential.
- Standard geotechnical consideration area. Mixed alluvial sand and gravel.

001 Road Parcel Number
 001 Parcel Number
 1.00 Acreage
 202 Parcel Sub/Seq Number
 PB 24-45 Plat Recording Number
 5 Block Number
 5 Lot Number
 GL5 Gov. Lot Number

BOOK	T22S R60E		
	164	163	162
	175	176	177
	193	192	191

SEC.	17					
	6	5	4	3	2	1
	7	8	9	10	11	12
	18	17	16	15	14	13
	19	20	21	22	23	24
	30	29	28	27	26	25
	31	32	33	34	35	36

MAP	S 2 NE 4			
	8	4	8	4
	5	1	5	1
	6	2	6	2
	7	3	7	3
	8	4	8	4
	5	1	5	1

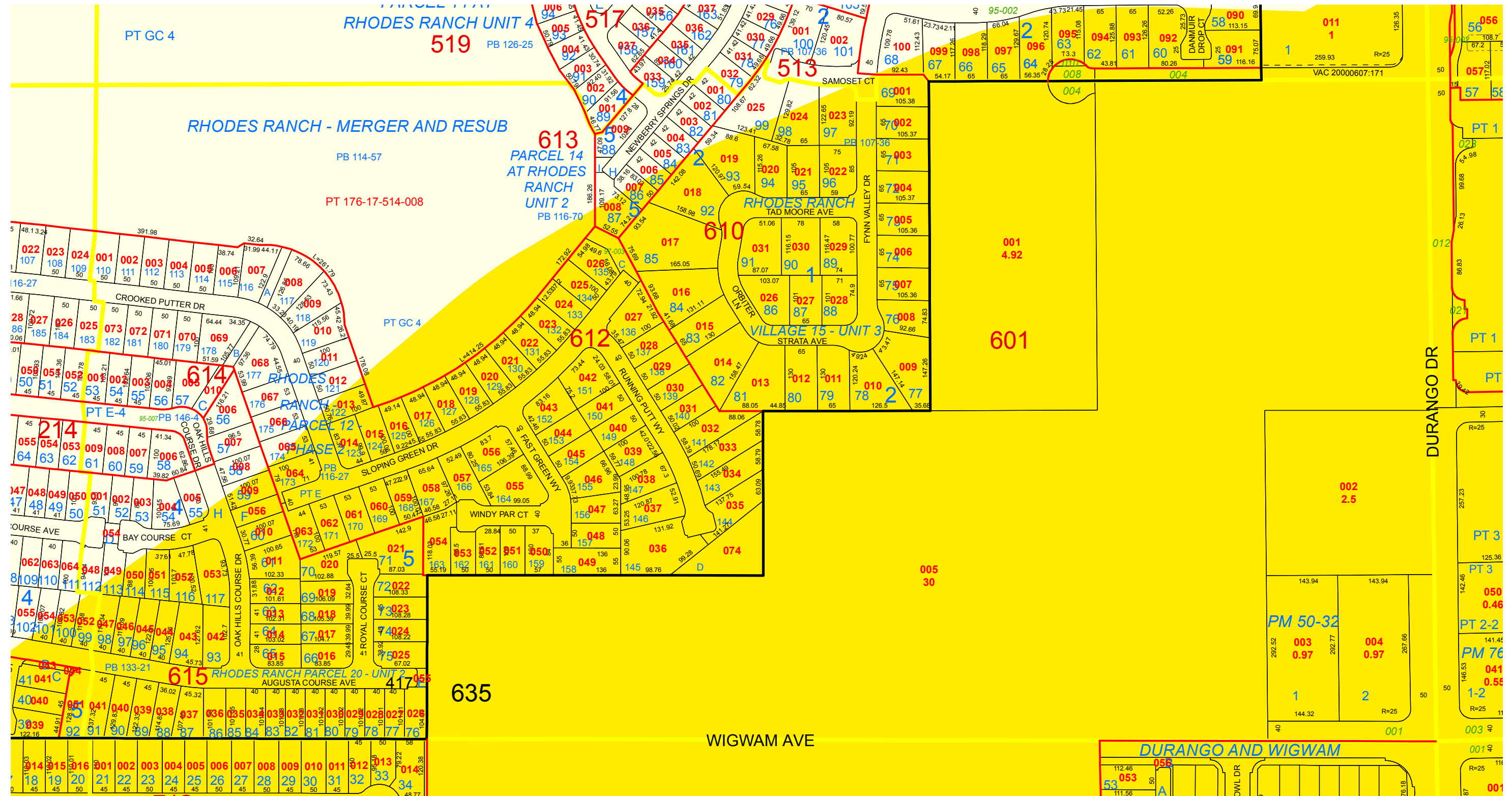
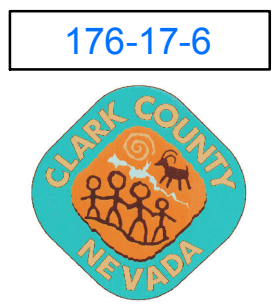

Official Soil Maps are maintained and located in the Clark County Building Department. All Conditions shown on this map are for informational purposes only.