

Date: 5/12/2019

- Easement Line
- Historical Lot Line
- Subdivision Line
- Tax District Line
- Page Index Boundary
- Parcel Boundary

- Special geotechnical consideration area. Steep slopes (greater than 15%) and shallow bedrock.
- Special geotechnical consideration area. Subsidence and 2,000 foot compaction or seismic fault buffer zone (includes 90% of mapped fissures).
- Special geotechnical consideration area. Potential drainage areas or recent sediment deposits. May also have solubility, clay swell, corrosion, gypsum salt, expansive or hydro-collapsible potential.
- Special geotechnical consideration area. Solubility, clay swell, corrosion, gypsum salt, expansive or hydro-collapsible potential.
- Standard geotechnical consideration area. Mixed alluvial sand and gravel.

001 Road Parcel Number
 001 Parcel Number
 1.00 Acreage
 202 Parcel Sub/Seq Number
 PB 24-45 Plat Recording Number
 5 Block Number
 5 Lot Number
 GL5 Gov. Lot Number

BOOK T21S R60E

SEC. 10

MAP N 2 SW 4

163-10-3

137	138	139
164	163	162
175	176	177

6	5	4	3	2	1
7	8	9	10	11	12
18	17	16	15	14	13
19	20	21	22	23	24
30	29	28	27	26	25
31	32	33	34	35	36

8	4	8	4
5	1	5	1
6	2	6	2
7	3	7	3
8	4	8	4
5	1	5	1

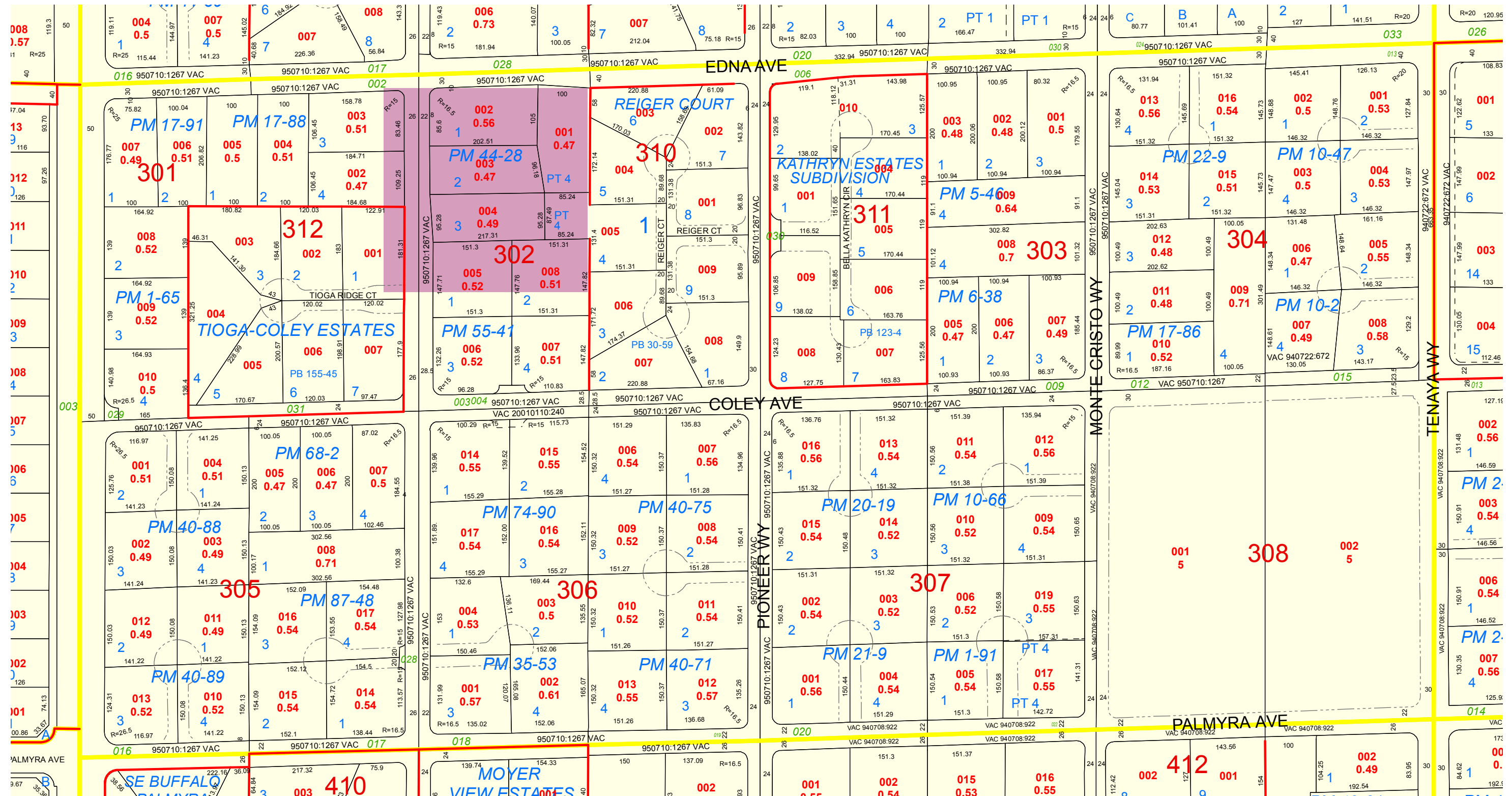

Official Soil Maps are maintained and located in the Clark County Building Department. All Conditions shown on this map are for informational purposes only.