

Date: 5/12/2019

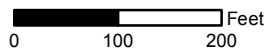

- Easement Line
- - - Historical Lot Line
- Subdivision Line
- Tax District Line
- Page Index Boundary
- Parcel Boundary

- Special geotechnical consideration area. Steep slopes (greater than 15%) and shallow bedrock.
- Special geotechnical consideration area. Subsidence and 2,000 foot compaction or seismic fault buffer zone (includes 90% of mapped fissures).
- Special geotechnical consideration area. Potential drainage areas or recent sediment deposits. May also have solubility, clay swell, corrosion, gypsum salt, expansive or hydro-collapsible potential.
- Special geotechnical consideration area. Solubility, clay swell, corrosion, gypsum salt, expansive or hydro-collapsible potential.
- Standard geotechnical consideration area. Mixed alluvial sand and gravel.

001 Road Parcel Number  
 001 Parcel Number  
 1.00 Acreage  
 202 Parcel Sub/Seq Number  
 PB 24-45 Plat Recording Number  
 5 Block Number  
 5 Lot Number  
 GL5 Gov. Lot Number

BOOK	T19S R60E		
099	100	101	
126	125	124	
137	138	139	

SEC.	31					
6	5	4	3	2	1	
7	8	9	10	11	12	
18	17	16	15	14	13	
19	20	21	22	23	24	
30	29	28	27	26	25	
31	32	33	34	35	36	

MAP	S 2 NE 4			
8	4	8	4	
5	1	5	1	
6	2	6	2	
7	3	7	3	
8	4	8	4	
5	1	5	1	

125-31-6

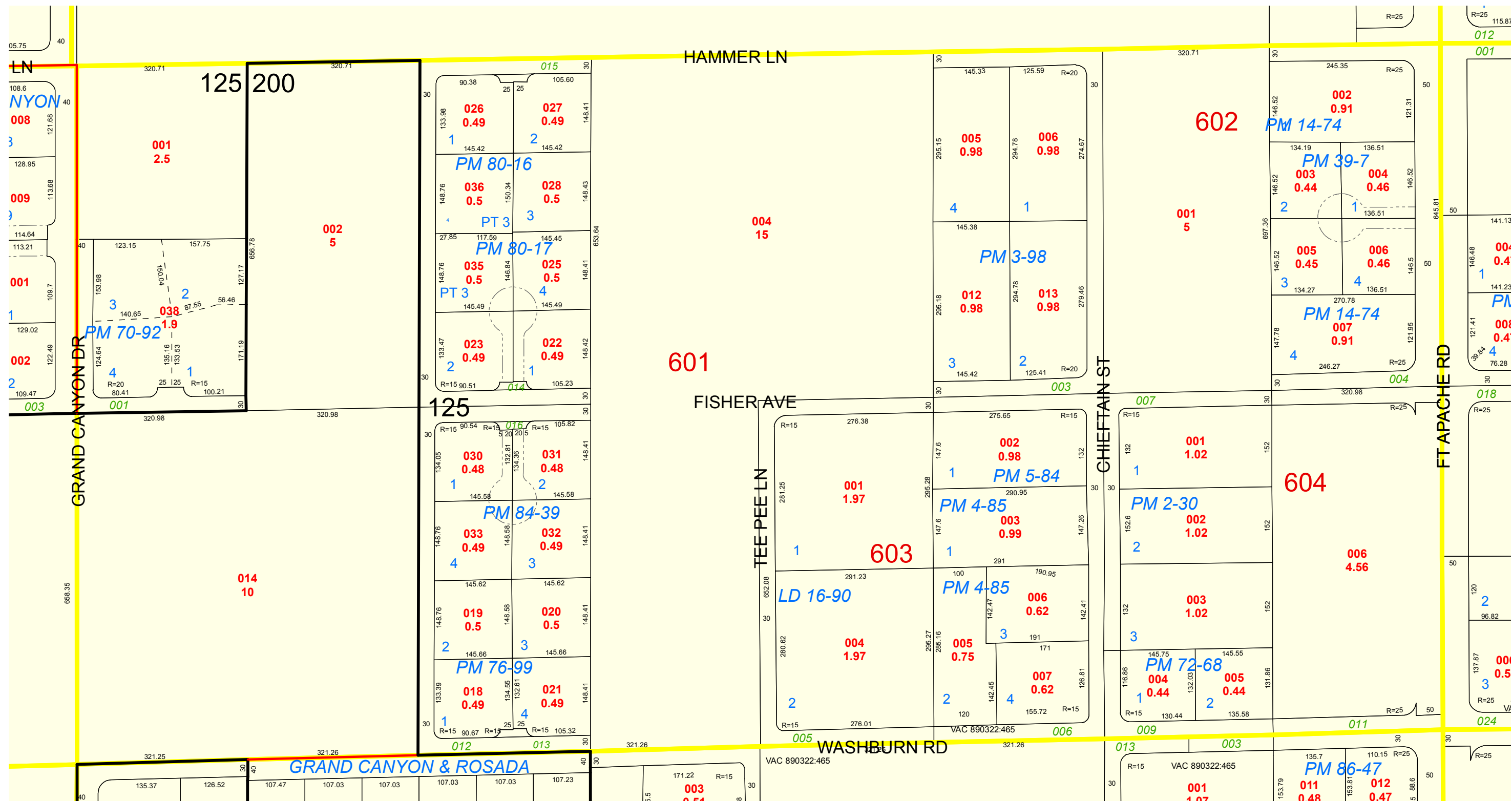

Official Soil Maps are maintained and located in the Clark County Building Department. All Conditions shown on this map are for informational purposes only.