

This map is for assessment use only and does NOT represent a survey.

No liability is assumed for the accuracy of the data delineated herein. Information on roads and other non-assessed parcels may be obtained from the Road Document Listing in the Assessor's Office.

This map is compiled from official records, including surveys and deeds, but only contains the information required for assessment. See the recorded documents for more detailed legal information.

NOTES



# ASSESSOR'S PARCELS - CLARK COUNTY, NV.

Briana Johnson - Assessor

- |       |                         |   |                  |          |                       |
|-------|-------------------------|---|------------------|----------|-----------------------|
| —     | PARCEL BOUNDARY         | □ | CONDOMINIUM UNIT | 001      | ROAD ID NUMBER        |
| - - - | SUB BOUNDARY            | ■ | AIR SPACE PCL    | 001      | PARCEL NUMBER         |
| —     | PM/LD BOUNDARY          | ■ | RIGHT OF WAY PCL | 1.00     | ACREAGE               |
| - - - | ROAD EASEMENT           | ■ | SUB-SURFACE PCL  | 202      | PARCEL SUB/SEQ NUMBER |
| - - - | NON-PARCEL LOT LINE     |   |                  | PB 24-45 | PLAT RECORDING NUMBER |
| - - - | MATCH / LEADER LINE     |   |                  | 5        | BLOCK NUMBER          |
| - - - | HISTORIC SUB BOUNDARY   |   |                  | 5        | LOT NUMBER            |
| - - - | HISTORIC PM/LD BOUNDARY |   |                  | GL5      | GOV. LOT NUMBER       |
| - - - | SECTION LINE            |   |                  |          |                       |

BOOK T22S R59E

SEC. 34

MAP ALL SEC

175-34-0

165	164	163
174	175	176
194	193	192
202	203	204

6	5	4	3	2	1
7	8	9	10	11	12
18	17	16	15	14	13
19	20	21	22	23	24
30	29	28	27	26	25
31	32	33	34	35	36

8	4	8	4
5	1	5	1
6	2	6	2
7	3	7	3
8	4	8	4
5	1	5	1



Scale: 1" = 800'

Rev: 1/7/2019

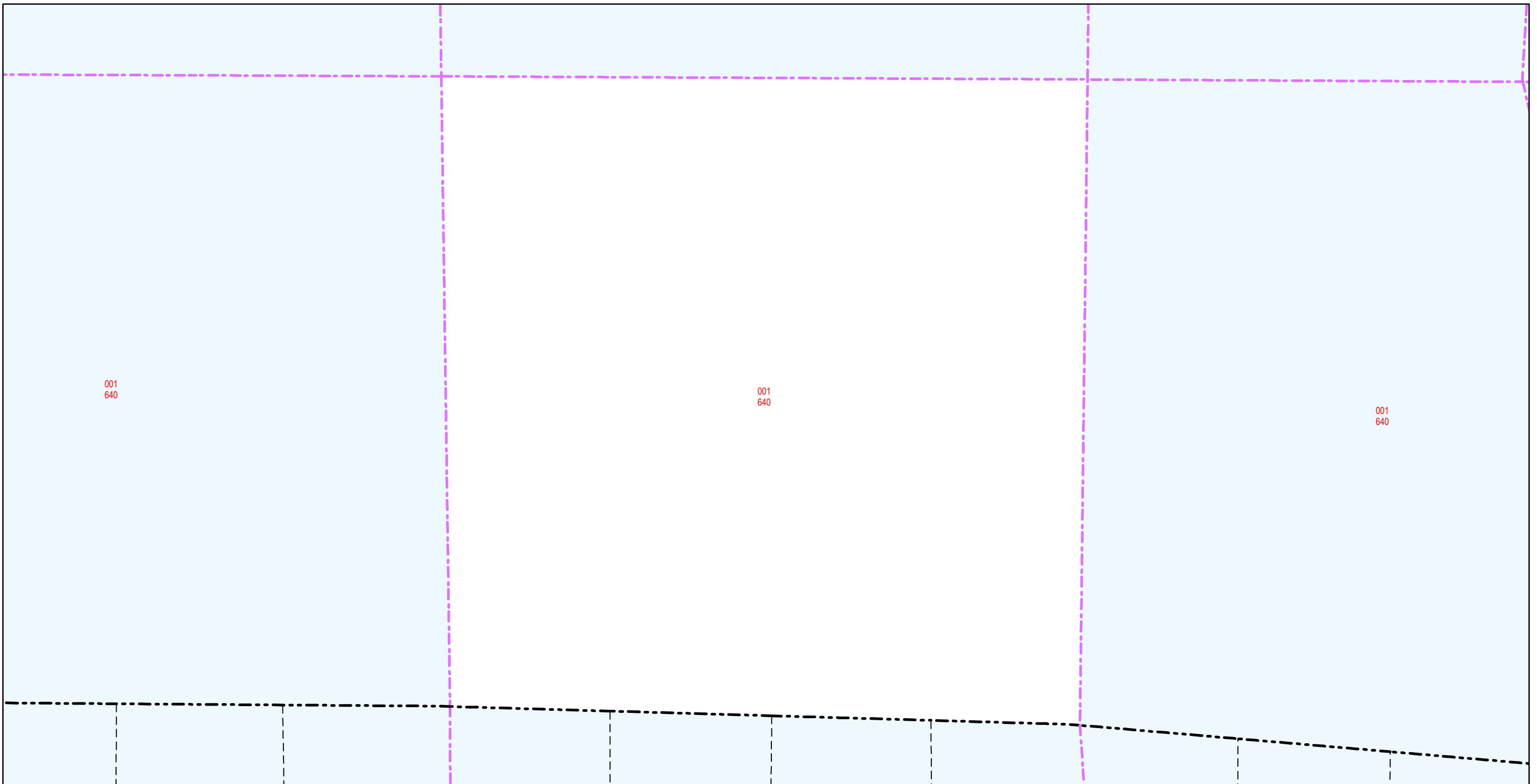

TAX DIST 100