

This map is for assessment use only and does NOT represent a survey.

No liability is assumed for the accuracy of the data delineated herein. Information on roads and other non-assessed parcels may be obtained from the Road Document Listing in the Assessor's Office.

This map is compiled from official records, including surveys and deeds, but only contains the information required for assessment. See the recorded documents for more detailed legal information.

NOTES

## ASSESSOR'S PARCELS - CLARK COUNTY, NV.

Briana Johnson - Assessor

BOOK **T18S R55E**

SEC. **36**

MAP **ALL SEC**

**095-36-0**

- |       |                         |   |                  |          |                       |
|-------|-------------------------|---|------------------|----------|-----------------------|
| —     | PARCEL BOUNDARY         | □ | CONDOMINIUM UNIT | 001      | ROAD ID NUMBER        |
| - - - | SUB BOUNDARY            | □ | AIR SPACE PCL    | 001      | PARCEL NUMBER         |
| —     | PM/LD BOUNDARY          | □ | RIGHT OF WAY PCL | 1.00     | ACREAGE               |
| - - - | ROAD EASEMENT           | □ | SUB-SURFACE PCL  | 202      | PARCEL SUB/SEQ NUMBER |
| - - - | NON-PARCEL LOT LINE     |   |                  | PB 24-45 | PLAT RECORDING NUMBER |
| - - - | MATCH / LEADER LINE     |   |                  | 5        | BLOCK NUMBER          |
| - - - | HISTORIC SUB BOUNDARY   |   |                  | 5        | LOT NUMBER            |
| - - - | HISTORIC PM/LD BOUNDARY |   |                  | GL5      | GOV. LOT NUMBER       |
| - - - | SECTION LINE            |   |                  |          |                       |

093	092	091	091
094	095	096	097
131	130	129	128
132	133	134	135

6	5	4	3	2	1
7	8	9	10	11	12
18	17	16	15	14	13
19	20	21	22	23	24
30	29	28	27	26	25
31	32	33	34	35	36

8	4	8	4
5	1	5	1
6	2	6	2
7	3	7	3
8	4	8	4
5	1	5	1

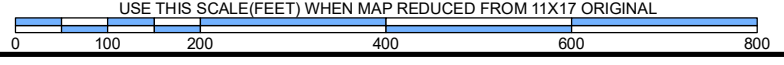

Scale: 1" = 800'

Rev: 1/7/2019

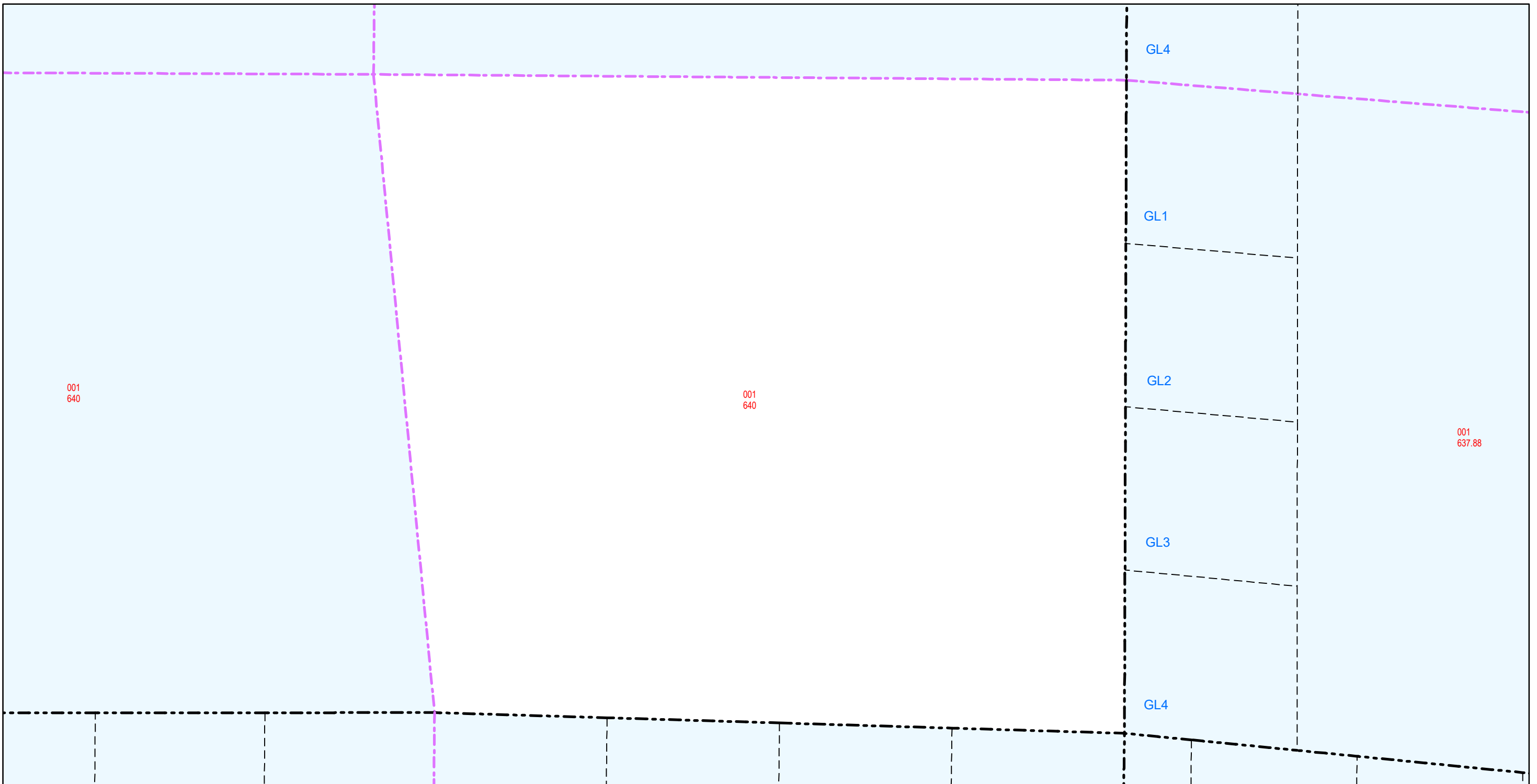

TAX DIST 100