

This map is for assessment use only and does NOT represent a survey.

No liability is assumed for the accuracy of the data delineated herein. Information on roads and other non-assessed parcels may be obtained from the Road Document Listing in the Assessor's Office.

This map is compiled from official records, including surveys and deeds, but only contains the information required for assessment. See the recorded documents for more detailed legal information.

USE THIS SCALE(FEET) WHEN MAP REDUCED FROM 11X17 ORIGINAL

ASSESSOR'S PARCELS - CLARK COUNTY, NV.

Briana Johnson - Assessor

| | | | | | |
|--|-------------------------|--|------------------|--|--------------------------------|
| | PARCEL BOUNDARY | | CONDOMINIUM UNIT | | 001 ROAD PARCEL NUMBER |
| | SUB BOUNDARY | | AIR SPACE PCL | | 001 PARCEL NUMBER |
| | PM/LD BOUNDARY | | RIGHT OF WAY PCL | | 1.00 ACREAGE |
| | ROAD EASEMENT | | SUB-SURFACE PCL | | 202 PARCEL SUB/SEQ NUMBER |
| | MATCH / LEADER LINE | | | | PB 24-45 PLAT RECORDING NUMBER |
| | HISTORIC LOT LINE | | | | 5 BLOCK NUMBER |
| | HISTORIC SUB BOUNDARY | | | | 5 LOT NUMBER |
| | HISTORIC PM/LD BOUNDARY | | | | GL5 GOV. LOT NUMBER |
| | HISTORIC SUB BOUNDARY | | | | |
| | HISTORIC PM/LD BOUNDARY | | | | |
| | HISTORIC SUB BOUNDARY | | | | |
| | HISTORIC PM/LD BOUNDARY | | | | |
| | HISTORIC SUB BOUNDARY | | | | |

| | | | | |
|------|-----------|---|---|---|
| BOOK | T23S R62E | | | |
| SEC. | 17 | | | |
| MAP | N 2 SW 4 | | | |
| | 8 | 4 | 8 | 4 |
| | 5 | 1 | 5 | 1 |
| | 6 | 2 | 6 | 2 |
| | 7 | 3 | 7 | 3 |
| | 8 | 4 | 8 | 4 |
| | 5 | 1 | 5 | 1 |

| | | |
|-------|-----|-----|
| 76177 | 178 | 179 |
| 92191 | 190 | 189 |
| 04205 | 206 | 207 |

Scale: 1" = 200'

Rev: 1/8/2019

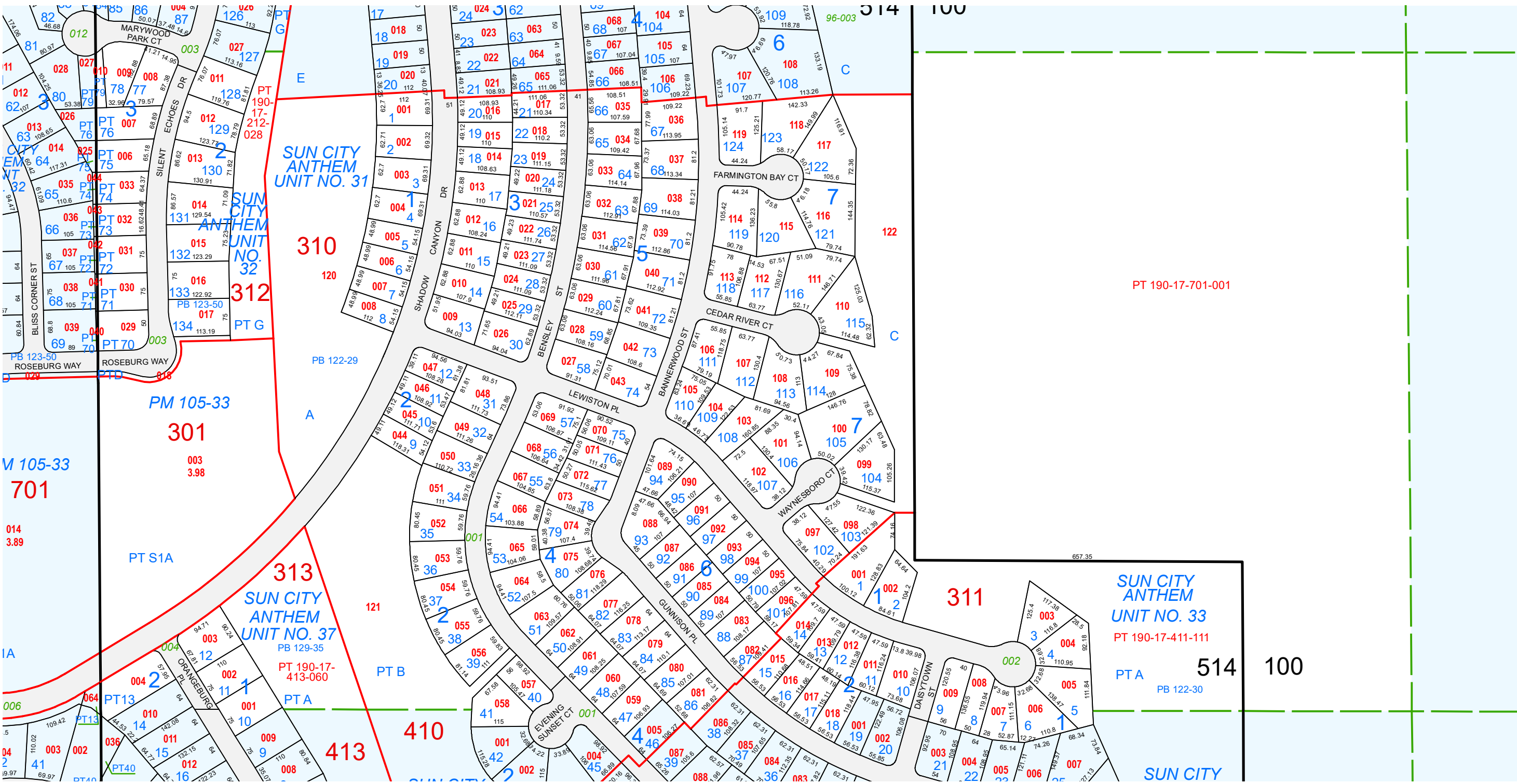

TAX DIST 514,100