

This map is for assessment use only and does NOT represent a survey.

No liability is assumed for the accuracy of the data delineated herein. Information on roads and other non-assessed parcels may be obtained from the Road Document Listing in the Assessor's Office.

This map is compiled from official records, including surveys and deeds, but only contains the information required for assessment. See the recorded documents for more detailed legal information.

USE THIS SCALE (FEET) WHEN MAP REDUCED FROM 11X17 ORIGINAL

ASSESSOR'S PARCELS - CLARK COUNTY, NV.

Briana Johnson - Assessor

- | | | |
|-------------------------|------------------|--------------------------------|
| PARCEL BOUNDARY | CONDOMINIUM UNIT | 001 ROAD PARCEL NUMBER |
| SUB BOUNDARY | AIR SPACE PCL | 001 PARCEL NUMBER |
| PMLD BOUNDARY | RIGHT OF WAY PCL | 1.00 ACREAGE |
| ROAD EASEMENT | SUB-SURFACE PCL | 202 PARCEL SUB/SEQ NUMBER |
| MATCH / LEADER LINE | | PB 24-45 PLAT RECORDING NUMBER |
| HISTORIC LOT LINE | | 5 BLOCK NUMBER |
| HISTORIC SUB BOUNDARY | | 5 LOT NUMBER |
| HISTORIC PM/LD BOUNDARY | | GL5 GOV. LOT NUMBER |
| SECTION LINE | | |
| TAX DISTRICT LINE | | |

BOOK T22S R63E

SEC. 28

MAP N 2 SE 4

179-28-7

161	16015958
178	179 180 181
190	188 186 187

6	5	4	3	2	1
7	8	9	10	11	12
13	14	15	16	17	18
19	20	21	22	23	24
25	26	27	28	29	30
31	32	33	34	35	36

8	4	8	4
5	1	5	1
6	2	6	2
7	3	7	3
8	4	8	4
5	1	5	1



Scale: 1" = 200'

Rev: 8/17/2021

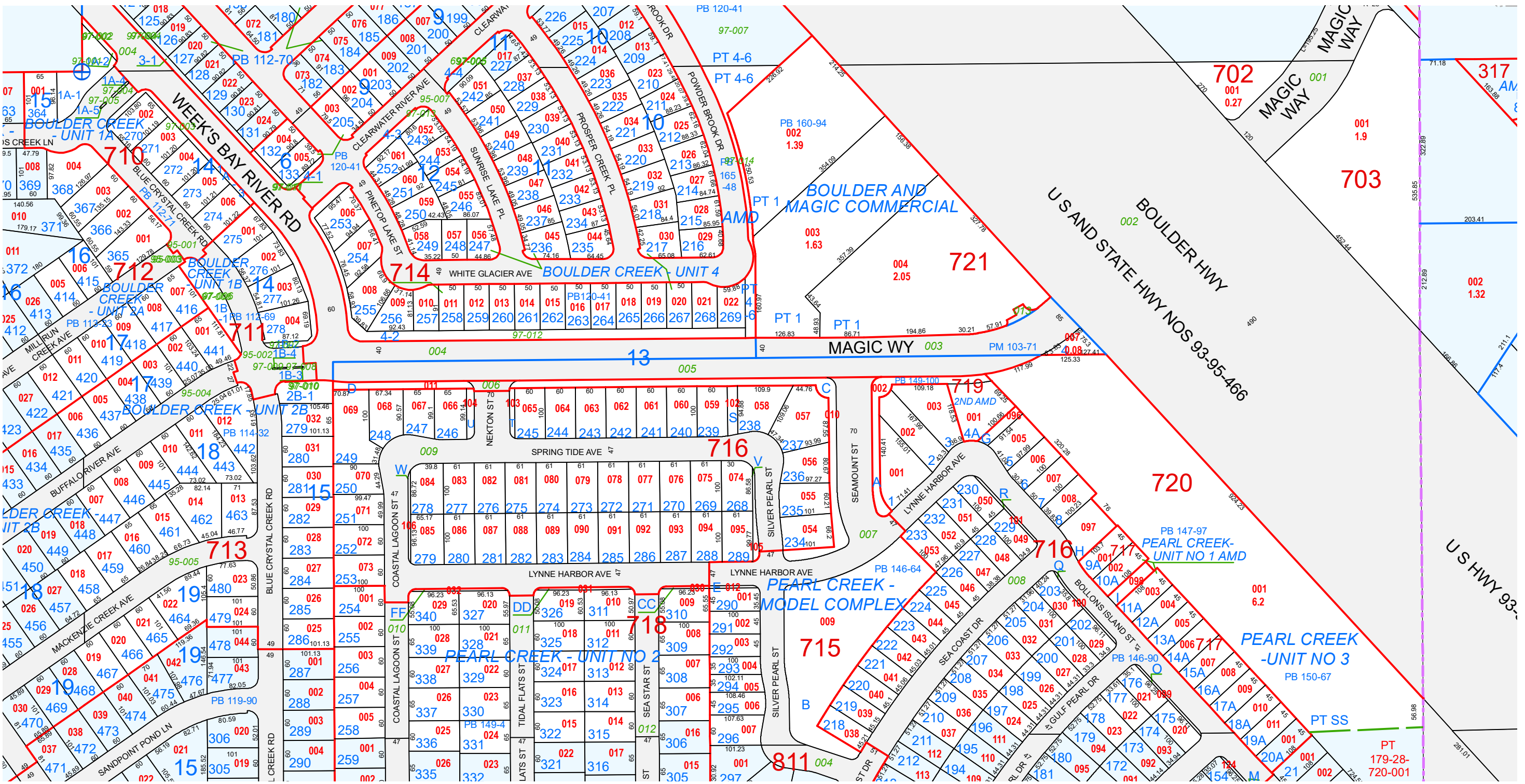

TAX DIST 505